

ALLDAY
& MILLER



Central House, Pembroke Road, Ruislip, HA4 8PR
£425,000





Central House, Pembroke Road, Ruislip, HA4 8PR

£425,000

- Two Double Bedroom
- Allocated Parking Space
- Short Walk to Ruislip Station
- Secure Entrance with Security Phone
- Open Plan Living
- Two Bathroom
- Exclusive Gated Development
- Lift
- Master Bedroom with En Suite
- Moments From Ruislip High Street

Description

Entry to Central House is via a private lobby, with an intercom controlling access to the front door which is covered by CCTV. There is both a lift and staircase to the upper floors. On entrance through the oak veneer door, the apartment briefly comprises hallway, contemporary open plan lounge kitchen. The lounge has large windows providing lots of natural light and the kitchen includes integrated cooker and unit mounted lighting. The kitchen is a very high specification with a ceramic hob and extractor hood and integrated white goods. The apartment has two double bedrooms. The master bedroom benefitting from an Ensuite shower room with bespoke vanity units and porcelain tiles. The modern family bathroom is sleek and benefits from mood lighting.

Outside

There is an allocated parking space and well maintained communal areas all set behind secure gated entrance.

Situation

This exclusive gated apartment is a stones throw from Ruislip High Street where a vast number of shops, restaurants and transports links can be found to include Waitrose, Tesco Express, Cafe Rouge and numerous coffee bars. Ruislip station (Metropolitan/Piccadilly lines) is a short walk away providing reliable links into the City and West End. Alternatively approximately half a mile away, West Ruislip station is serviced by both tube (Central line) and train lines into Marylebone Station in just 25 minutes, with regular trains every 15 minutes. For the motorist the A40/M25 is a short drive away providing access to Central London and the Home Counties. For families, there are a number of highly regarded schools that cater for children of all ages within close proximity including BWI, Sacred Heart and Bishop Ramsey. Ruislip Woods, Highgrove and Ruislip Bowls club are all 5-10 minutes walk away.



Floor Plans

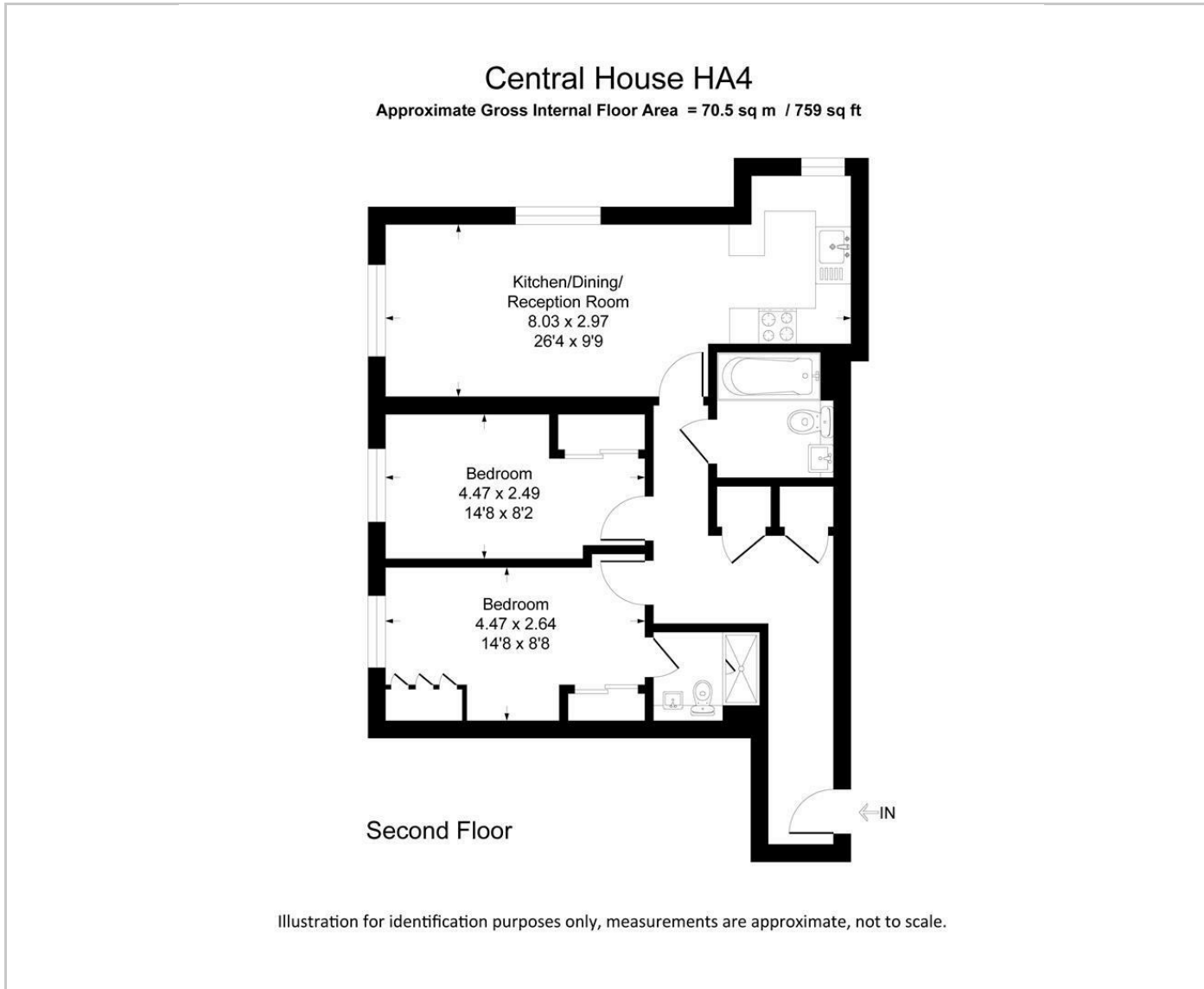

Area Map

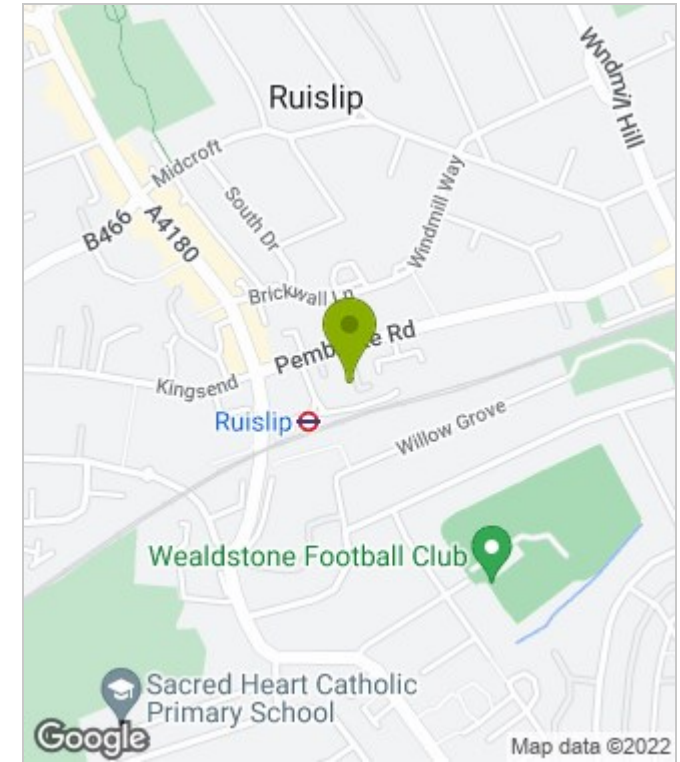

Energy Performance Graph



These particulars, whilst believed to be accurate are set out as a general outline only for guidance and do not constitute any part of an offer or contract. Intending purchasers should not rely on them as statements of representation of fact, but must satisfy themselves by inspection or otherwise as to their accuracy. No person in this firm's employment has the authority to make or give any representation or warranty in respect of the property.

www.alldayandmiller.co.uk

192 High Street, Uxbridge, Middlesex, UB8 1LB

T: 01895 641 000 | E: sales@alldayandmiller.co.uk

T: 01895 379 549 | E: lettings@alldayandmiller.co.uk